

New American  
Stone Mills North LLC

1780 Hardwood Flats Rd.  
Wolcott, VT 05680  
802-279-8833

Stone Mill 40"  
With Integrated Sifter

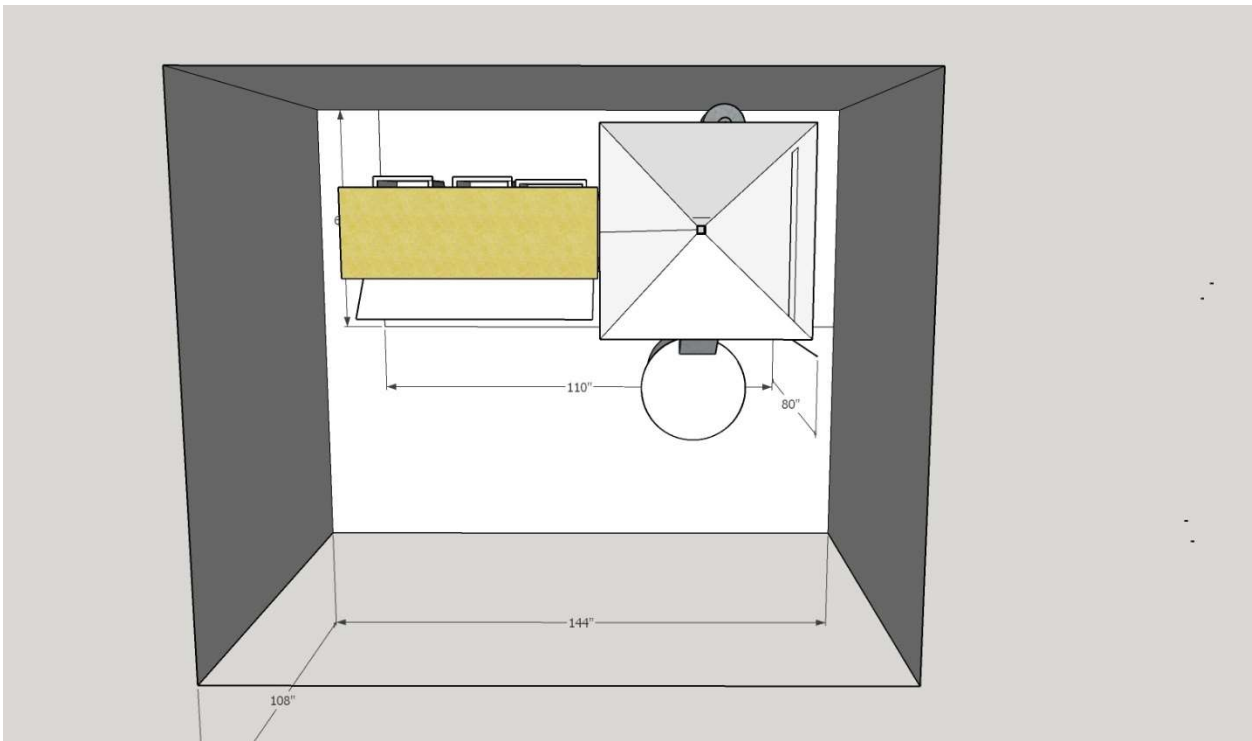

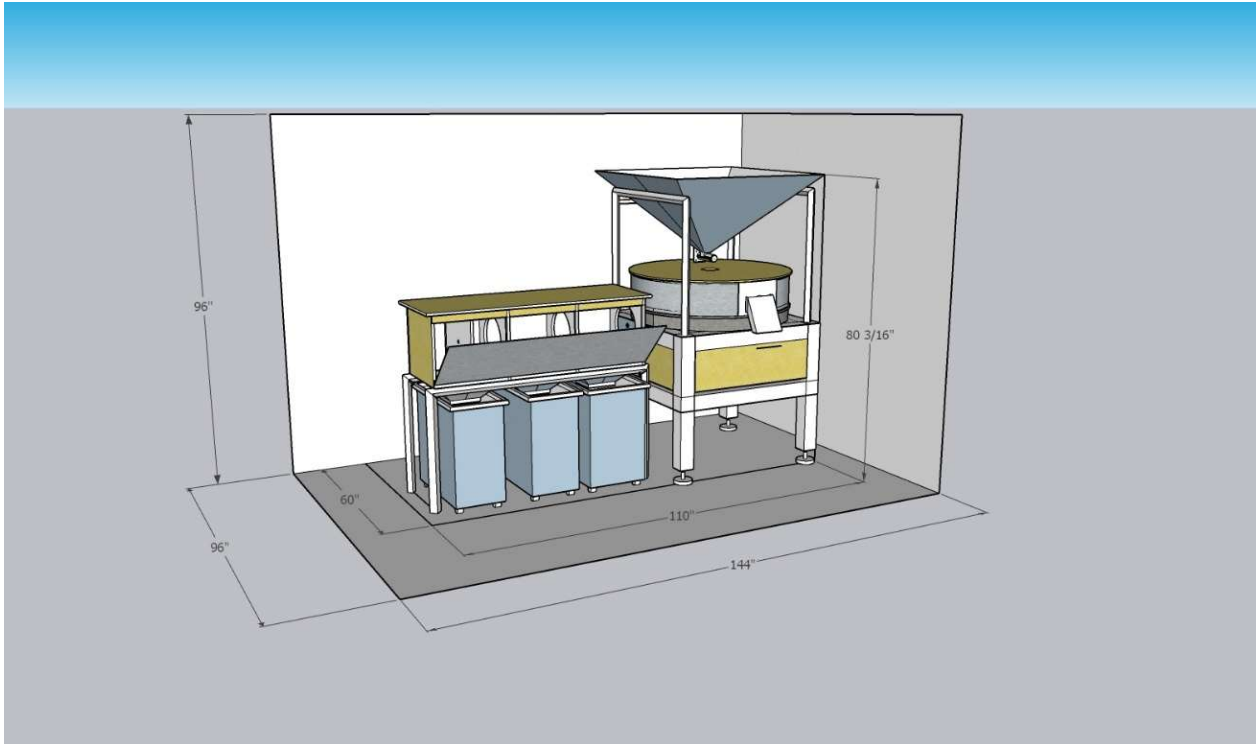

# Cut Sheet

- 40" Natural Barre Gray Granite millstones
- Welded steel frame, powder coated white
- 10 hp 3 phase motor TEFC UL listed
- Variable Frequency Drive for 3 phase service-NEMA 4 dust proof -soft starts, stops and adjusts motor speed-UL listed
- Stone casing- Baltic birch plywood with stainless steel lining
- Stainless hopper, approximately 300 lb. capacity
- Leveling Vibration Dampening Feet
- Integrated crane and yoke device for removing and flipping runner stone
- Wooden Safety guard around pulleys and drive belts
- Accurate Hand wheel stone adjustment with readout
- Volumetric auger and speed control for grain feed
- Canvas bucket cover to accommodate 55 Gallon bucket
- 230 RPM Production Rate 100-150 pounds per hour
- Footprint is 46"W x 63"D and 80"H 3300 lbs.
- Granite Millstones require annual re-dressing for optimum performance
- Milling, maintenance and stone dressing instructions included

**Sifter**

- Mild steel frame, powder coated white
- 3/4 hp 3 phase motor with starter TEFC UL listed-Wired to mill panel
- Flour casing- plywood with stainless steel
- 3 outlets for flour, middlings and bran
- Removable screens for cleaning
- One set of fine 275 micron screens and one set of medium 400 micron screens
- Canvas sleeves for discharge included.
- Sifter Footprint is 20" wide by 60" long by 50" tall  
Approximately 300 lbs.

**Requirements:**

- Floor-suitable to support 3000 lb. load
- Doorway-minimum 48" wide to receive mill
- Ceiling height 9' minimum
- Minimum recommended room size 12'x 10'
- Electrical Service-One Circuit 200-240 Volt Three Phase with 50 Amps capacity. Requires hardwire installed by a certified electrician.